

LOOVENT eco dMEV

Continuous ventilation



KEY FEATURES

- Continuous running centrifugal fan
- Trickle flow rate from 25 m³/h
- Boost flow rate up to 110 m³/h
- Compact design - smallest footprint in class
- Ideal for New Build and Refurbishments in toilets, bathrooms, en-suites, utility rooms and kitchens (adjacent to hob)
- Surface or recessed, portrait or landscape
- Simple replacement of existing Loovent - same mounting and spigot position
- Economical to operate - from 2.8 W
- Timer and humidity timer versions
- SELV versions - low voltage
- Voltage supply 100 / 240 V - 50 / 60 Hz
- IPX5 rating
- Complies with Building Regulations
- SAP eligible
- 5 year warranty

The next generation...

The dMEV continuous ventilation versions are the ideal solution for maintaining the perfect air quality in the domestic home. The LOOVENT eco dMEV versions with timer and humidity timer functionality are SAP eligible, making them perfect for the new build market.

The trickle rate should be selected on installation depending on the application - 7 l/s for toilets, 9 l/s for bathrooms / en-suites / utility rooms and 16 l/s for kitchens. Boost speed is activated by the pull cord, humidity sensor or a remote switch (light / door switch).

Boost speeds are 15, 15 and 31 l/s respectively. The pre-set run on timer period will apply and revert back to the trickle speed after this time.

LOOVENT eco is ideal for replacing the old Loovent 01C or existing Loovent 01 as the spigot position is identical and the back plates are the same size keeping reworking to a minimum.



MODELS

Timer / SELV T	Timer can be set to run on between 2 and 45 minutes
Humidity Timer / SELV HT	Humidity sensor can be set between 40 - 90% RH

TECHNICAL DATA

Specification	LOOVENT eco dMEV		
Air flow m ³ /h (trickle / boost)	25 / 55	33 / 55	59 / 110
Air flow l/s (trickle / boost)	7 / 15	9 / 15	16 / 31
Fan type	Centrifugal		
Controls	Timer / Humidity Timer		
Sound Pressure dB(A)@3 m	25 / 46	25 / 46	28 / 46
Power watts	2.8 / 8.9	3 / 8.9	2.8 / 12
Amps	3		
Specific Fan Power (SFP)	0.40 / 0.59	0.32 / 0.59	0.17 / 0.40
Building Regulations ADF	Yes		
Duct diameter (mm)	100		
Voltage	100/240 V - 50/60 Hz		
Rating	IPX5		
Weight (kg)	1.0		
Dimensions (H x W x D) mm	167 x 187 x 138		
Part No.	72684308 (T)	72684311 (HT)	
	72684312 (SELV)	72684313 (SELV)	

DIMENSIONS (mm)

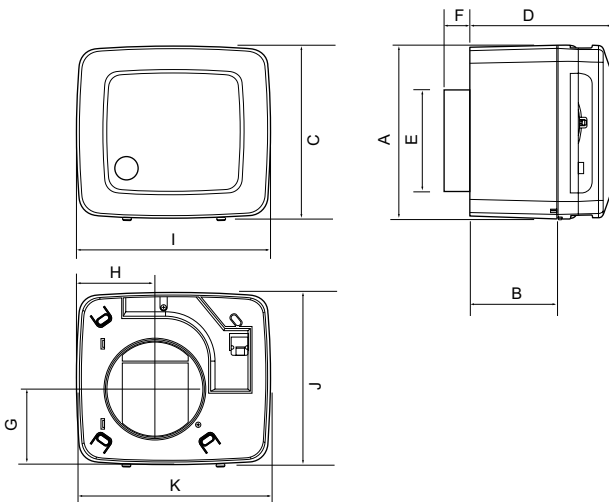

Model	A	B	C	D	E	F	G	H	I	J	K
LOOVENT eco	167	85.5	167	138.5	99	22	74.5	75	187	162.6	182.6



PERFORMANCE

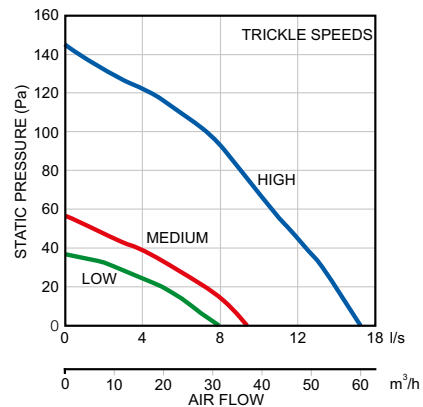

SAP PERFORMANCE

Unit configuration	Location	Flow rate	Specification fan power (W/l/s)
In room 	Kitchen	13.3 l/s	0.18
	Wet room	7 or 9.3 l/s	0.31
Through wall 	Kitchen	16.9 l/s	0.19
	Wet room	10.0 l/s	0.33

CONTROLS AND ACCESSORIES

A range of accessories including flexible and rigid ducting kits, controls, switches and grilles are available.

See accessories section for more details.



Call: 01494 525252

Visit: airflow.com



Airflow Developments Limited
 Aidelle House, Lancaster Road,
 Cressex Business Park,
 High Wycombe, Buckinghamshire,
 United Kingdom, HP12 3QP

E-mail: info@airflow.com
 Telephone: +44 (0) 1494 525252

airflow.com

© Airflow Developments Limited. Airflow Developments Limited reserve the right, in the interests of continuous development, to alter specifications without prior notice. All orders are accepted subject to our conditions of sale which are available on request



80001419 - Issue 1 07/23